

## INSTALLATION INSTRUCTIONS TWIN PENDANT WITH P1EE HANGING SYSTEM

These Instructions cover the TWIN LUMINAIRE with the following options:

SERIES	HANGING SYSTEM	SIZE	LIGHT SOURCE	CIRCUIT OPTION	CONTROL	WIRE DIAGRAM
TW1 - TWIN	P1EE: PENDANT WITH ANGLED AIRCRAFT CABLES AND POWER CORD TO COLLECTOR THEN SINGLE CENTER STEM TO CANOPY	24"	STATIC WHITE	SINGLE CIRCUIT	0-10V DIM 1% (DM1)	WIRE DIAGRAM ON PAGE 6
		36"		DUAL CIRCUIT		WIRE DIAGRAM ON PAGE 7
		48"				
		60"				
		72"				

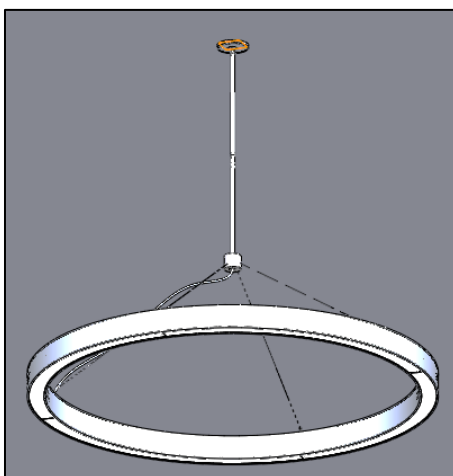

FIG. 1 – TW1-P1EE-MW-XX-XXX-LEDX\_XXK-UNV-XX-DM~

### GENERAL NOTES:

1. PLEASE COMPLETELY READ THE INSTALL INSTRUCTIONS BEFORE STARTING INSTALLATION.
2. TURN OFF POWER TO CIRCUIT FIXTURE WHILE IT IS BEING INSTALLED.
3. INSTALL IN ACCORDANCE WITH ALL LOCAL, STATE AND NATIONAL CODES CONSULT WITH A QUALIFIED ELECTRICIAN FOR PROPER INSTALLATION.
4. CAREFULLY UNPACK ALL CONTENTS; SOME COMPONENTS MAY HAVE BEEN SHIPPED IN SEPARATE BOXES. MOST FIXTURES ARE SHIPPED PARTIALLY ASSEMBLED. SOME UNASSEMBLY MAY BE REQUIRED FOR INSTALLATION.
5. DO NOT LET THE TWIN LUMINAIRE HANG FREE UNTIL ALL THE AIRCRAFT CABLES ARE SECURED AND EVENLY TENSIONED.
6. DUE TO A CHANGE IN NEC SECTION 410.69 EFFECTIVE IN 2022, THE COLOR PINK WILL BE USED IN PLACE OF GRAY FOR 0-10V CONTROL. NOTE THAT EXISTING SYSTEMS AND FIXTURES MANUFACTURED PRIOR TO 2022 MAY STILL USE GRAY WIRE AS AN UNGROUNDED CONDUCTOR FOR 0-10V CONTROL. CARE SHOULD BE TAKEN WHEN WORKING ON EXISTING SYSTEMS.

**OCL Architectural Lighting**

Phone: 314.863.1895

Fax: 314.863.3278

[www.ocl.com](http://www.ocl.com)

## Table of Contents

<b>GENERAL INFORMATION:</b> .....	<b>3</b>
<b>TWIN MOUNTING:</b> .....	<b>4</b>
<b>WIRE DIAGRAM</b> .....	<b>6</b>

**GENERAL INFORMATION:**

You will receive the following with each TWIN P1EE series pendant fixture:

1. TWIN LUMINAIRE with CORD attached. (Pre-assembled as shown in FIG. 2)
2. INSTALLATION INSTRUCTIONS (shown in FIG. 3) - Please completely read the install instructions before starting installation.
3. CANOPY AND STEM SUBASSEMBLY. (Pre-assembled as shown in FIG. 4)
4. COLLECTOR KIT as shown in FIG.5.
5. RED BAG (shown in FIG. 3) contains below following items.
  - a) FOUR (4) AIRCRAFT CABLE (shown in FIG. 6)

**WARNING: Examine all components for any damage before beginning installation.**

**WARNING: This fixture should be installed by a licensed electrician only.**

**WARNING: Be careful not to scratch or damage any finished parts.**

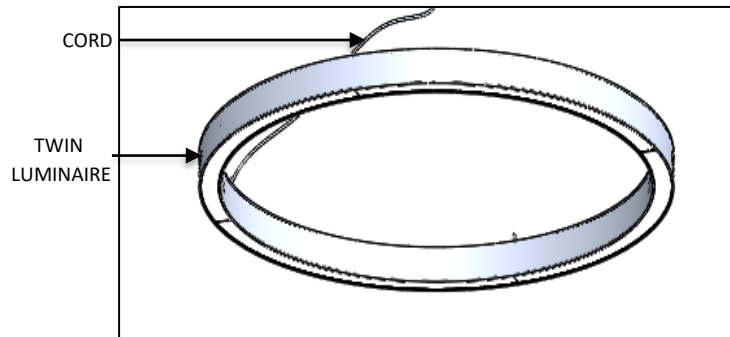

FIG. 2 - TWIN LUMINAIRE (PRE-ASSEMBLED)

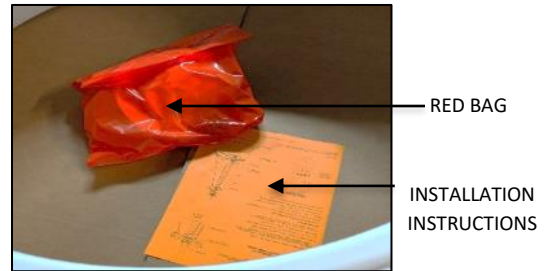

FIG.3 RED BAG AND INSTALLATION INSTRUCTIONS

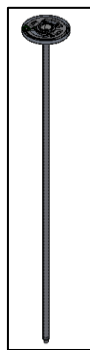

FIG.4 - CANOPY AND STEM SUBASSEMBLY

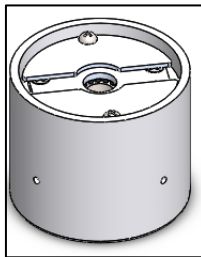

FIG. 5 - COLLECTOR KIT



FIG.6 AIRCRAFT CABLES

OCL Architectural Lighting

Phone: 314.863.1895

Fax: 314.863.3278

[www.ocl.com](http://www.ocl.com)

## TWIN MOUNTING:

1. Loosen canopy and slide down stem by rotating the canopy 90 degrees counterclockwise. Be careful not to damage the finish of the fixture. FIG. 7.
2. Mount the MOUNTING PLATE assembly to the junction box (by others) as in FIG. 8. if the fixture has a safety cable, attach this to a structural member.

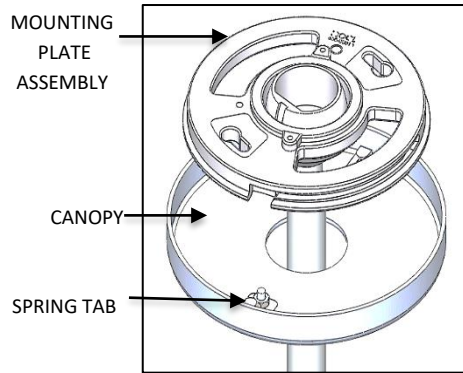

FIG. 7 – CANOPY DISASSEMBLY

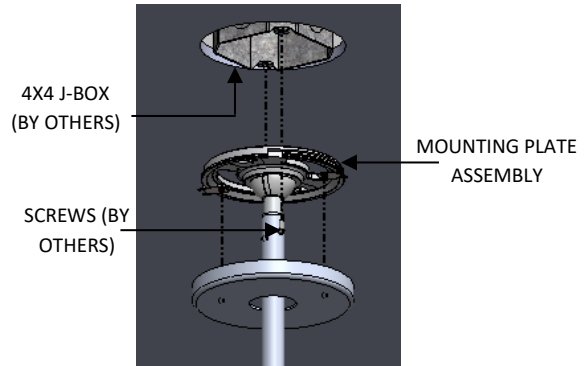

FIG. 8 - MOUNTING PLATE INSTALLATION

3. Attach the STEMS based upon the length required using COUPLER and SHOULDER as shown in FIG. 9. Use thread locker on all stem connections and fully tighten stem sections together.
4. Insert safety cable around the collector mounting bracket then attach the collector mounting bracket to the center stem with the provided hardware. Run the safety cable through the stem to the canopy. Feed aircraft cables through the small holes in the side of the collector. Attach the collector to the collector mounting bracket with provided hardware FIG.10.

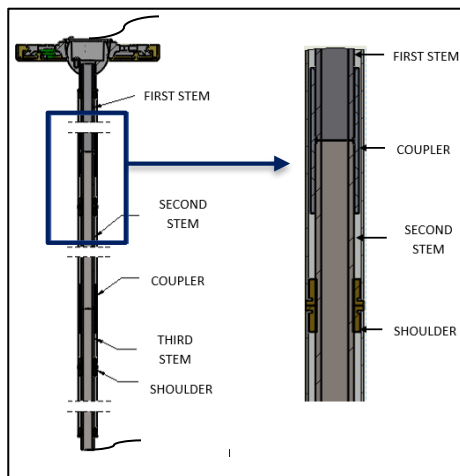

FIG. 9 – DETAIL SHOWING STEM INSTALLATION

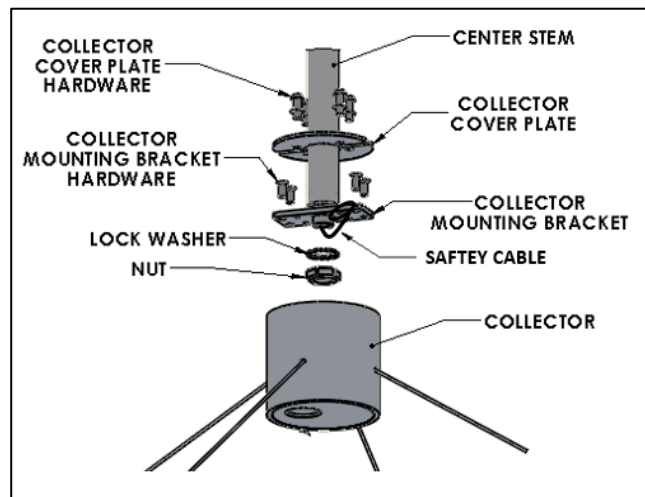

FIG. 10 – COLLECTOR INSTALLATION

5. Feed the wires through the assembled CENTER STEM as shown in FIG. 9.

OCL Architectural Lighting

Phone: 314.863.1895

Fax: 314.863.3278

[www.ocl.com](http://www.ocl.com)

## TW1-P1EE-XX-INSTALLATION INSTRUCTIONS

6. If fixture is less than 55lbs and will be mounted to a STANDARD JUNCTION box, refer to "SWIVEL CANOPY ASSEMBLY UNDER 55LBS INSTALL INSTRUCTIONS" for mounting the CANOPY to the JUNCTION BOX. If fixture is over 55lbs and needs to be structurally mounted, refer to "SWIVEL CANOPY ASSEMBLY OVER 55LBS INSTALL INSTRUCTIONS". See chart below for standard fixture weights as shown in FIG.11.

FIXTURE DIAMETER	FIXTURE WEIGHT	USE CANOPY INSTALL INSTRUCTIONS:
24"	35 LBS	SWIVEL CANOPY ASSEMBLY UNDER 55LBS
36"	50 LBS	SWIVEL CANOPY ASSEMBLY UNDER 55LBS
48"	65 LBS	SWIVEL CANOPY ASSEMBLY OVER 55LBS
60"	80 LBS	SWIVEL CANOPY ASSEMBLY OVER 55LBS
72"	95 LBS	SWIVEL CANOPY ASSEMBLY OVER 55LBS

FIG. 11 – STANDARD FIXTURE WEIGHT CHART

7. After the STEM ASSEMBLY is installed and hanging, attach the FOUR AIRCRAFT CABLES from the COLLECTOR to the GRIPLOCK at the fixture as shown in FIG.12. Each cable must be inserted at least 1.75" into the GRIPLOCK as shown in FIG. 14.

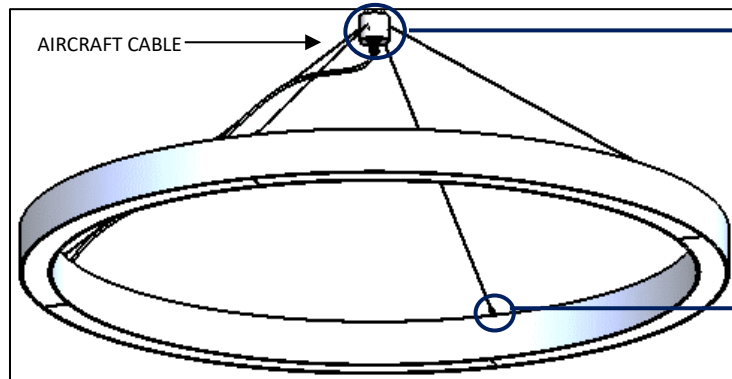

FIG. 12 – AIRCRAFT CABLE INSTALLATION

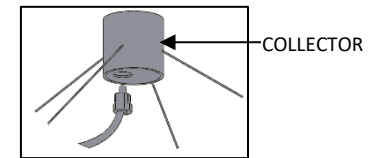

FIG. 13 – CORD INSTALLATION

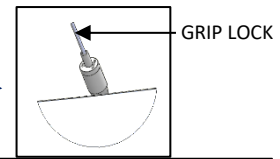

FIG. 14 – GRIPLOCK INSTALLATION

8. Feed the power cord through the bottom hole in the collector as shown in FIG.13. Make wire connections inside the collector between the cord and building supply wires in the center stem. In accordance with all local, state and national codes. Make sure to attach all green grounding wires to main building ground. Place strain relief around the cord and install it in the collector as shown in FIG. 13. Install the collector cover plates to the collector with the provided hardware as shown in FIG. 15.

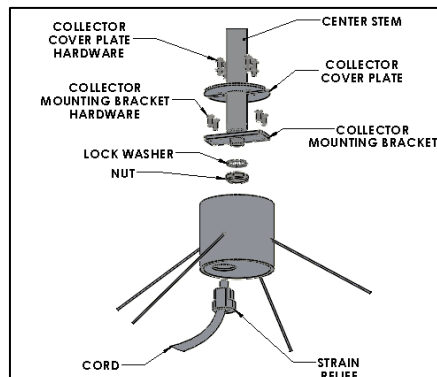

FIG. 15 – FIXTURE WIRING

**OCL Architectural Lighting**

Phone: 314.863.1895

Fax: 314.863.3278

[www.ocl.com](http://www.ocl.com)

## TW1-P1EE-XX-INSTALLATION INSTRUCTIONS

9. Make all wire connections inside the canopy in accordance with the NATIONAL ELECTRICAL CODE and all applicable LOCAL AND STATE CODES inside the JUNCTION BOX (BY OTHERS). See WIRE LABEL TABLE and WIRE DIAGRAMS for both single circuit and dual circuit wire connections.

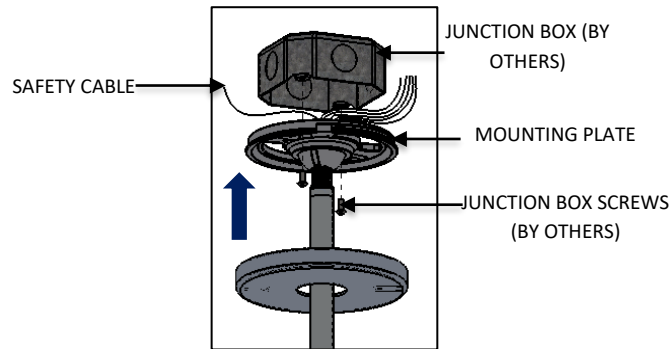
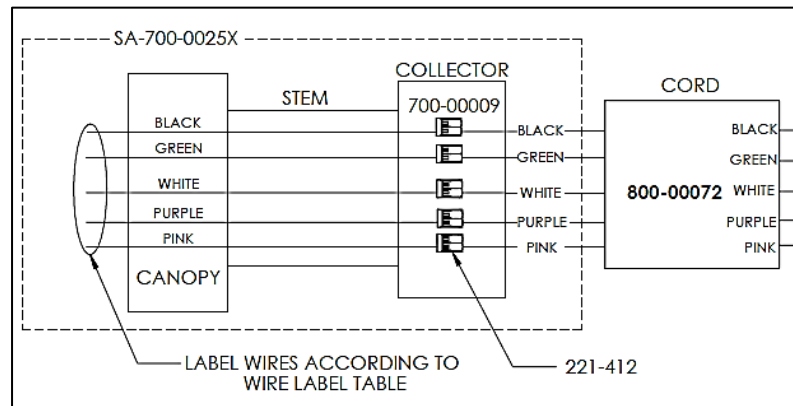

FIG. 16 – MOUNTING PLATE  
INSTALLATION TO JUNCTION BOX

SERIES	HANGING SYSTEM	SIZE	LIGHT SOURCE	CIRCUIT OPTION	CONTROL	WIRE DIAGRAM
1.TW1 (TWIN)	P1EE: PENDANT WITH ANGLED AIRCRAFT CABLES AND POWER CORD TO COLLECTOR THEN SINGLE CENTER STEM TO CANOPY	24"	STATIC WHITE	SINGLE CIRCUIT	0-10V DIM 1% (DM1)	WIRE DIAGRAM ON PAGE 6
		36"		DUAL CIRCUIT		WIRE DIAGRAM ON PAGE 7
		48"				
		60"				
		72"				

### SINGLE CIRCUIT WIRE DIAGRAM:



SEE GENERAL NOTE 6 ON PAGE 1  
FIG. 18 – WIRE DIAGRAM

WIRE LABEL TABLE		
CONTROL	WIRE COLOR	LABEL
ALL	BLACK	LINE VOLTAGE
ALL	WHITE	NEUTRAL
ALL	GREEN	GROUND
DM1	PURPLE	0-10V (+)
DM1	PINK	0-10V (-)

FIG. 17 – WIRE LABEL TABLE

OCL Architectural Lighting

Phone: 314.863.1895

Fax: 314.863.3278

[www.oclighting.com](http://www.oclighting.com)

## TW1-P1EE-XX-INSTALLATION INSTRUCTIONS

### DUAL CIRCUIT WIRE DIAGRAM :

WIRE LABEL TABLE		
CONTROL	WIRE COLOR	LABEL
ALL	RED	LINE VOLTAGE UPLIGHT
DM1	BLUE	0-10V (-) UPLIGHT
DM1	RED	0-10V (+) UPLIGHT
ALL	BLACK	LINE VOLTAGE DOWNLIGHT
ALL	WHITE	NEUTRAL UP AND DOWNLIGHT
ALL	GREEN	GROUND UP AND DOWNLIGHT
DM1	BLUE	0-10V (-) DOWNLIGHT
DM1	RED	0-10V (+) DOWNLIGHT

FIG. 18 – WIRE LABEL TABLE

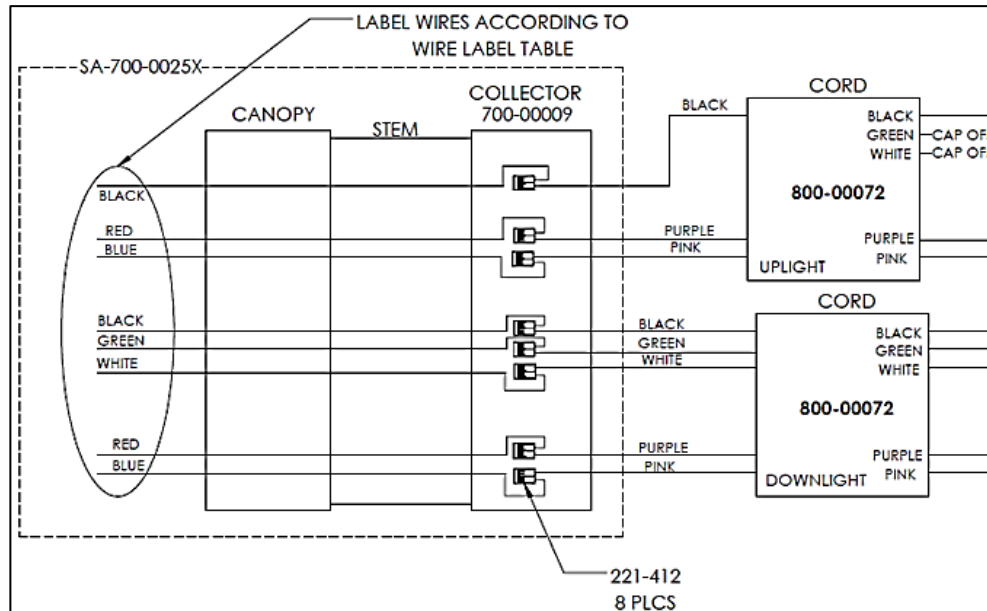

SEE GENERAL NOTE 6 ON PAGE 1  
FIG. 19 – WIRE DIAGRAM

10. Raise the CANOPY and tighten onto the MOUNTING BRACKET by lining the SPRING TABS up the NOTCHES in the MOUNTING BRACKET and rotating 90 degrees clockwise as shown in FIG. 20.

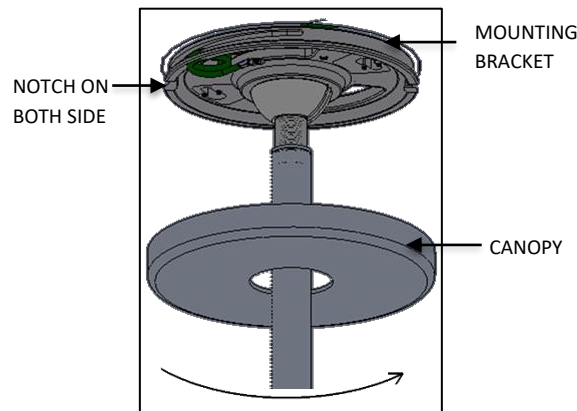

**OCL Architectural Lighting**

Phone: 314.863.1895

Fax: 314.863.3278

[www.ocl.com](http://www.ocl.com)

## TW1-P1EE-XX-INSTALLATION INSTRUCTIONS

11. Restore power to circuit the TWIN series pendant is connected to.
  - a. Test to see that the luminaire turns on after power is restored.
  - b. Contact OCL for any luminaire troubleshooting if a problem occurs.

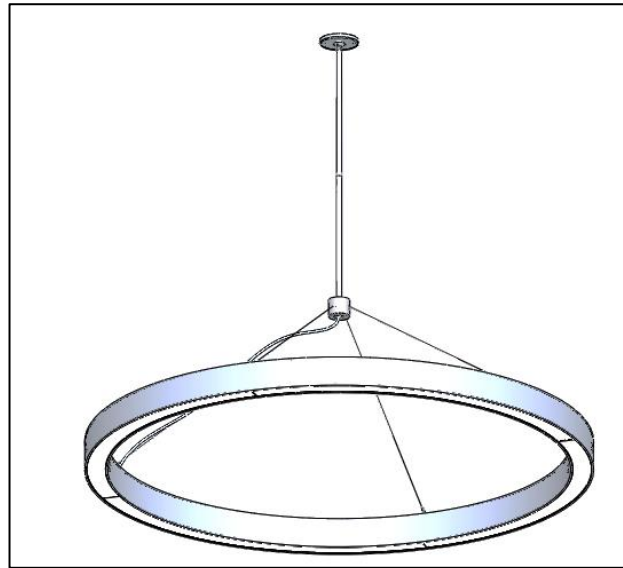

FIG. 21 - COMPLETED INSTALLATION OF TWIN  
PENDANT WITH P1EE HANGING SYSTEM  
TW1-P1EE-MW-XXX-LEDX\_XXK-UNV-XX-DM~  
(AS SHOWN)